

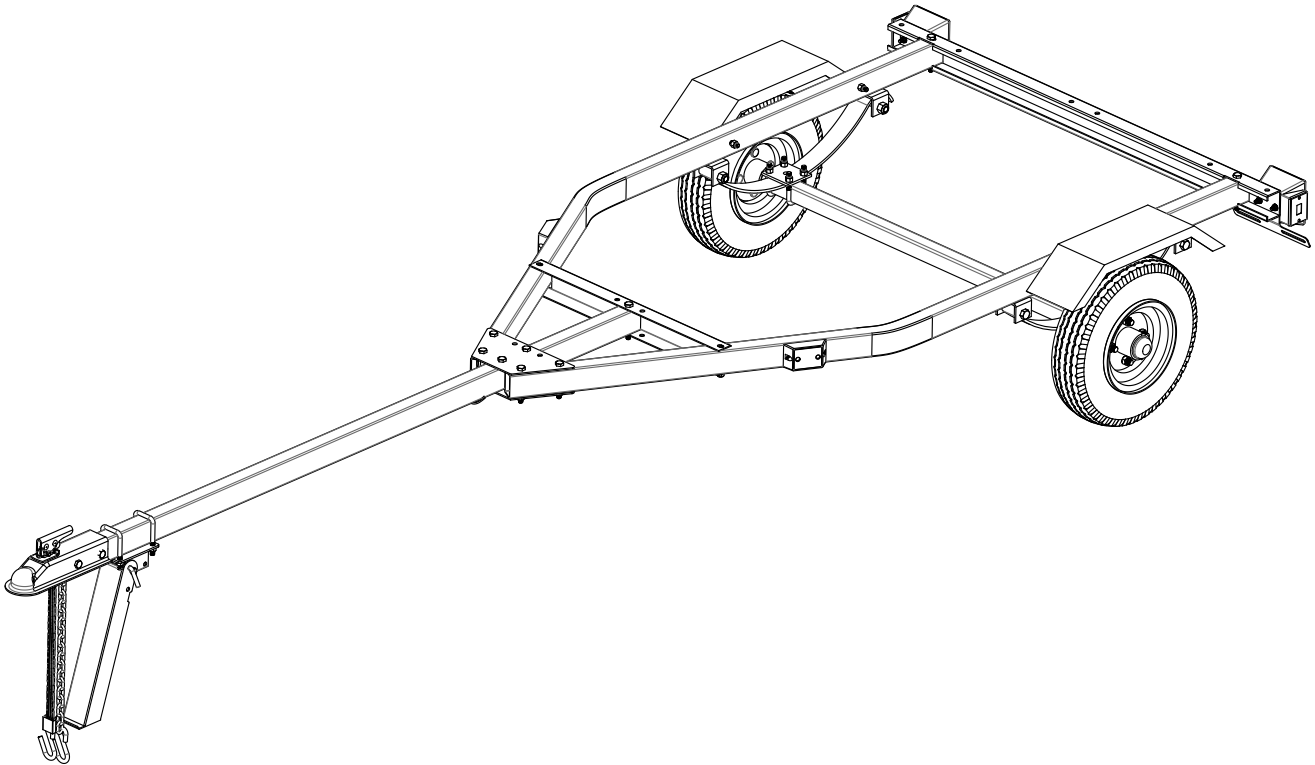



Road Trailer (Multi-Sport and Dolly Trailer)

Revision: C1



LCI-8791P Road Trailer
Shipping Weight: 157 lbs
Max Load Capacity: 300 lbs
Coupler Capacity: Class II, 2" ball
Tires: 4.80-8" tubeless, 4PR

 Approximate Assembly Time
3 - 5 hours

Parts List & Assembly Instructions

Trailer Parts		
No.	Item	Qty
1	Coupler	1
2	Coupler Base	2
3	Chain	1
4	Towbar	1
5	Stand Base	1
6	Stand Leg	1
7	Right Side Rail	1
8	Left Side Rail	1
9	Connecting Plate	2
10	Connecting Rod	1
11	Side Running Light	1
12	Spring (single leaf)	2
13	Spring Plate	2
14	Axle	1
15	Hub Assembly	2
16	Tire/Rim Assembly	2
17	Fender	2
18	Cross Member	1
19	License Plate Bracket	1
20	Left Tail Light	1
21	Right Tail Light	1
22	Wiring/Plug Assembly	1
23	Fender	2

Hardware		
No.	Item	Qty
A	Safety Pin (coupler)	1
B	Hairpin Cotter (coupler)	2
C	Pin 3/8" (stand)	1
D	Bolt M10 x 60mm	4
E	Bolt M10 x 85mm	12
F	Bolt M12 x 80mm (coupler)	2
G	Bolt M14 x 80mm (springs)	2
H	Flat Washer M10	26
I	Flat Washer M12	2
J	U-Bolt M10 x 85 (stand)	2
K	U-Bolt M10 x 75 (springs)	4
L	Nut M10 (nylon lock)	26
M	Nut M12 (nylon lock)	2
N	Nut M14 (nylon lock)	4
O	Lug Nut (hubs)	8
P	Castle Nut 3/4" (axle)	2
Q	Cotter Pin (axle)	2
R	Flat Washer 3/4" (axle)	2
S	Bearing L44643 (loose)	2
T	Dust Cap (hub)	2
U	Nut 1/4-20unc (tail lights)	4
V	Screw #8 (side running lights)	4
-	-	-
-	-	-

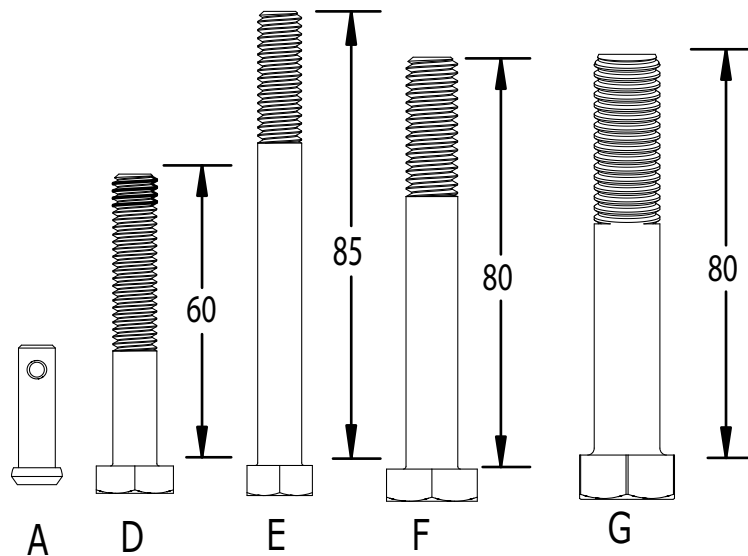

Parts List

Bolts - (image not full scale)

The tools you will need:

- Phillips-head screwdriver
- pliers
- wire stripper/cutter
- tape measure
- plastic/rubber mallet
- knife
- box wrenches (16mm, 17mm, 19mm, 21mm)
- sockets (10mm, 16mm, 17mm, 18mm, 19mm, 21mm, 22mm)
- adjustable wrench or channel lock pliers
- torque wrench
- grease gun and grease
- electrical tape

Identify and layout all bolts and fasteners before starting assembly

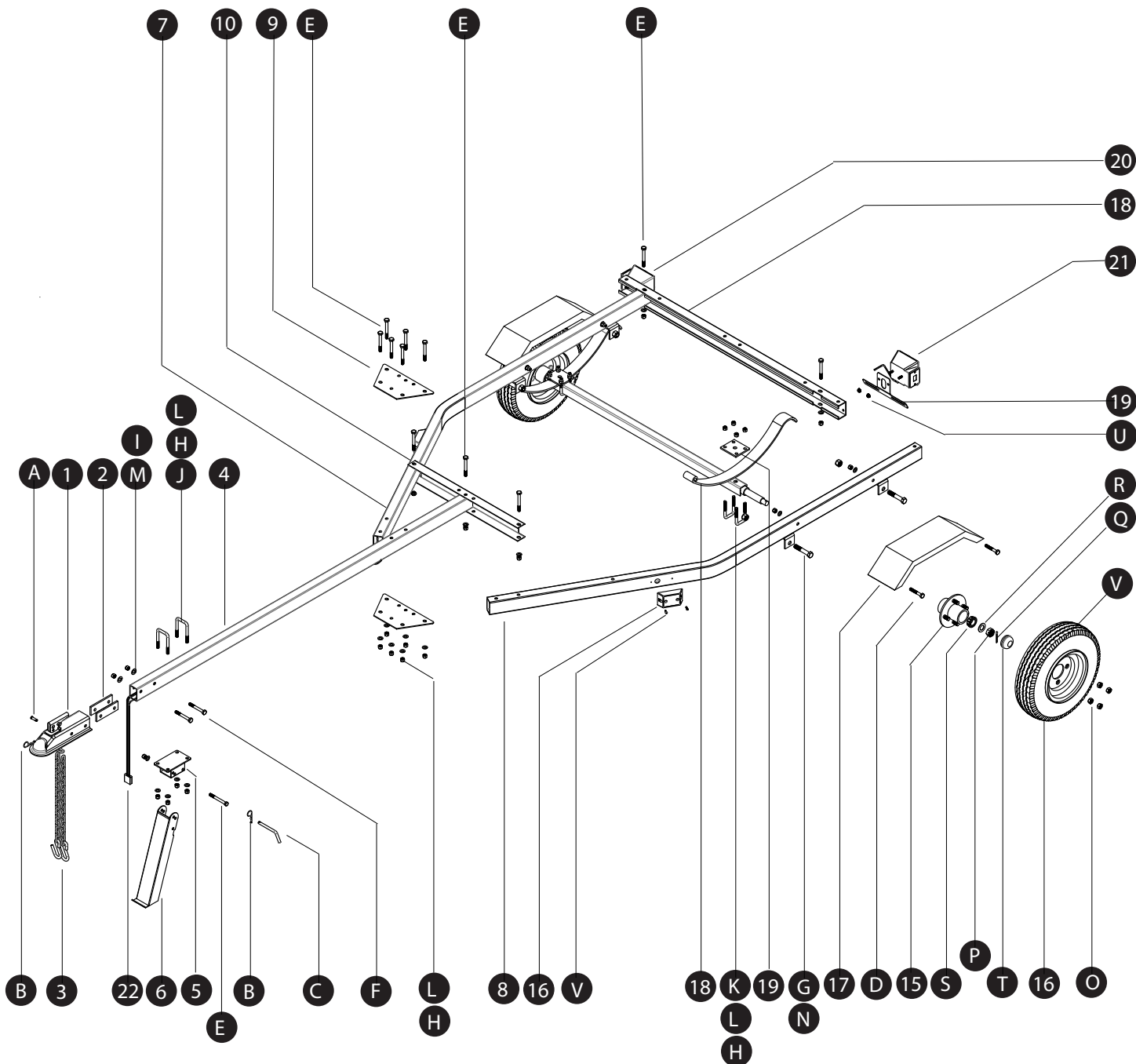

EXPLODED PARTS VIEW

STEP 0: Locate "CERTIFICATE OF ORIGIN" document packed with Towbar (4) in shipping carton (Box 2 - 75x5x4"). You will need this document to obtain a tag from DMV.

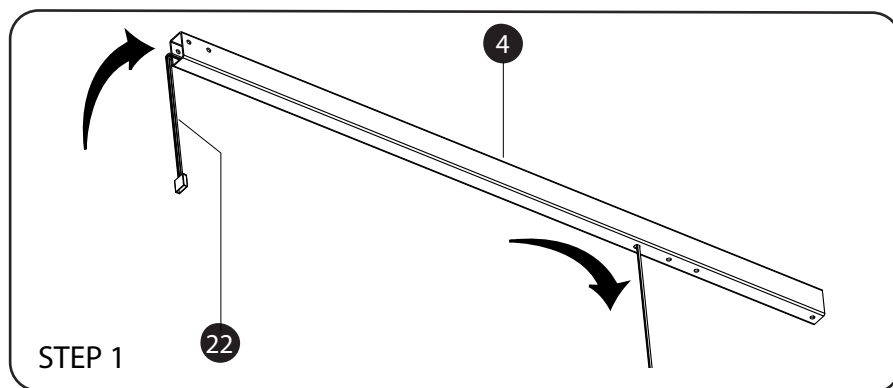

STEP 1: Route tail end of Wire/Plug Assembly (22) into open hitch end of Towbar (4) and out the 9/16" (15mm) hole in the bottom. A wiring fish tape can be used to pull wires. If needed a wiring fish tape can be constructed from 3 wire coat hangers that are twisted together end to end. Leave around 20" of wire protruding at the Hitch end. Be careful not to damage wires during the subsequent assembly processes.

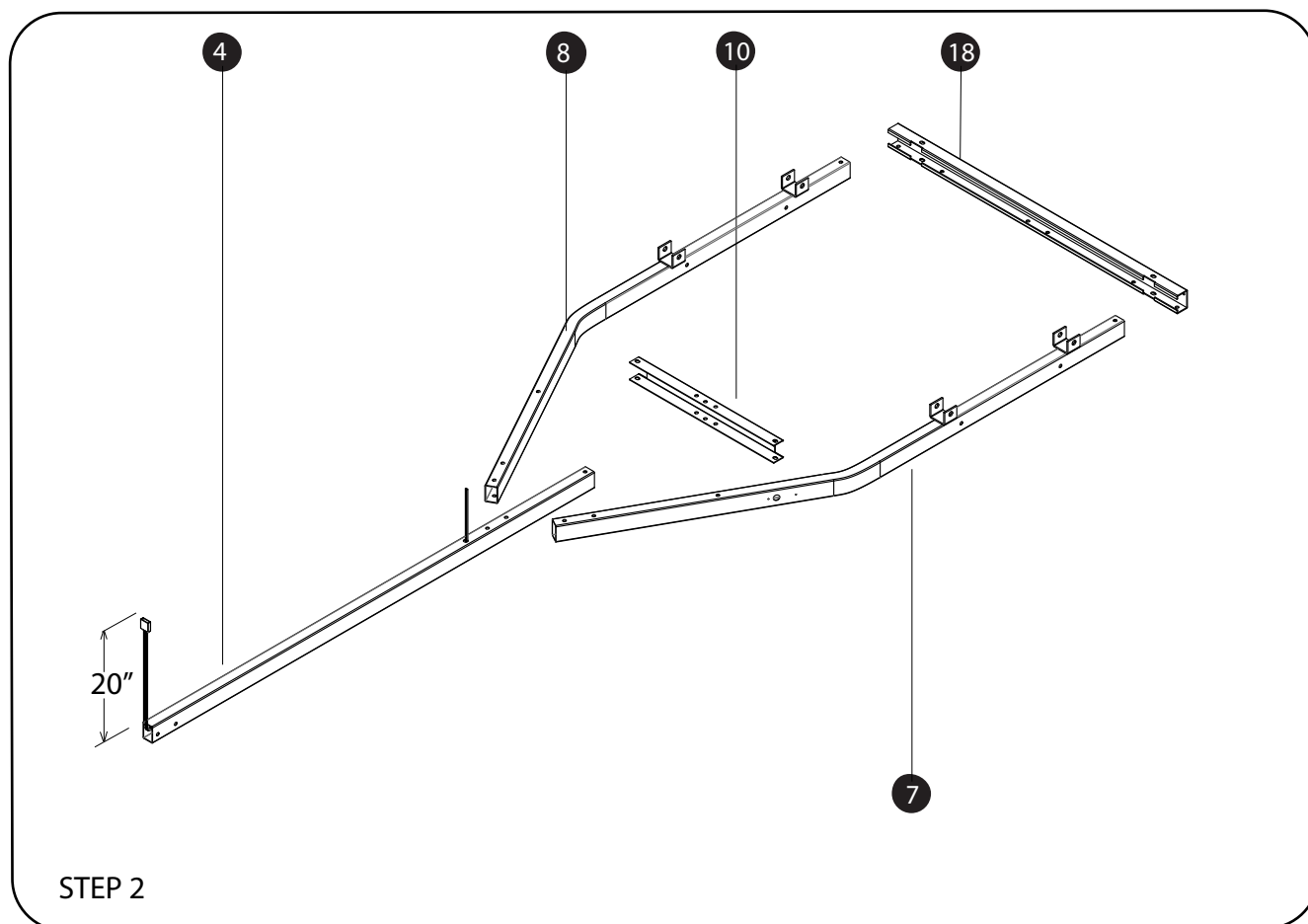

ASSEMBLY STEPS

STEP 2: Lay out Towbar (4), Right Side Rail (7), Left Side Rail (8), Connecting Rod (10), and Cross Member (18) upside down as shown.

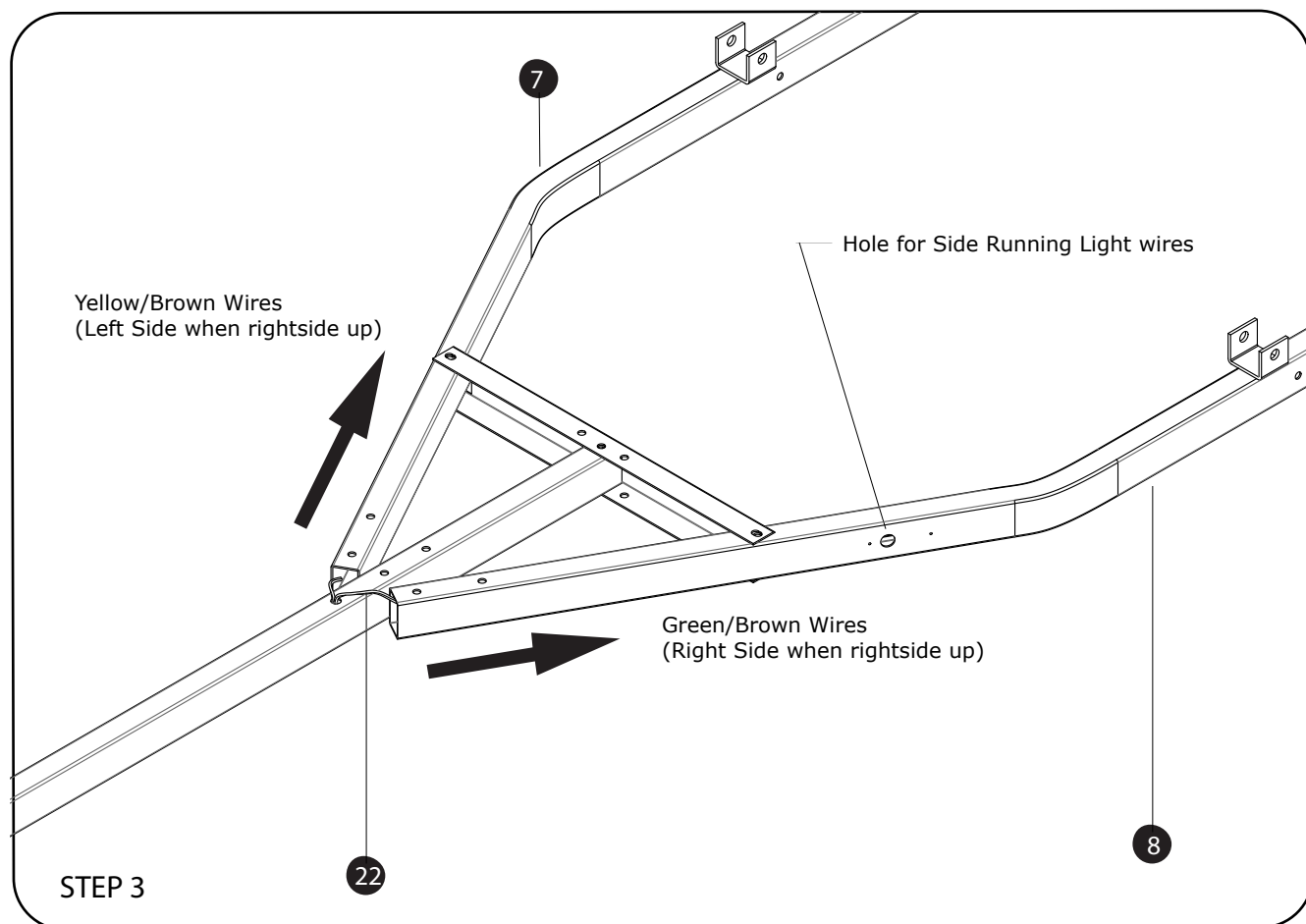

STEP 3: Route wires from hole in Towbar (4) through Left and Right Side Rails and out the holes in the Cross Member (18). Green/Brown Wires pass through Right Side Rail (7) and Yellow/Brown Wires pass through Left Side Rail (8). Adjust Wiring/Plug Assembly so the Plug is 18" to 20" from end of Towbar.

Use a tweezers or needle nose pliers to route leads for Side Running Lights (11) out the 20mm hole in the Side Rails.

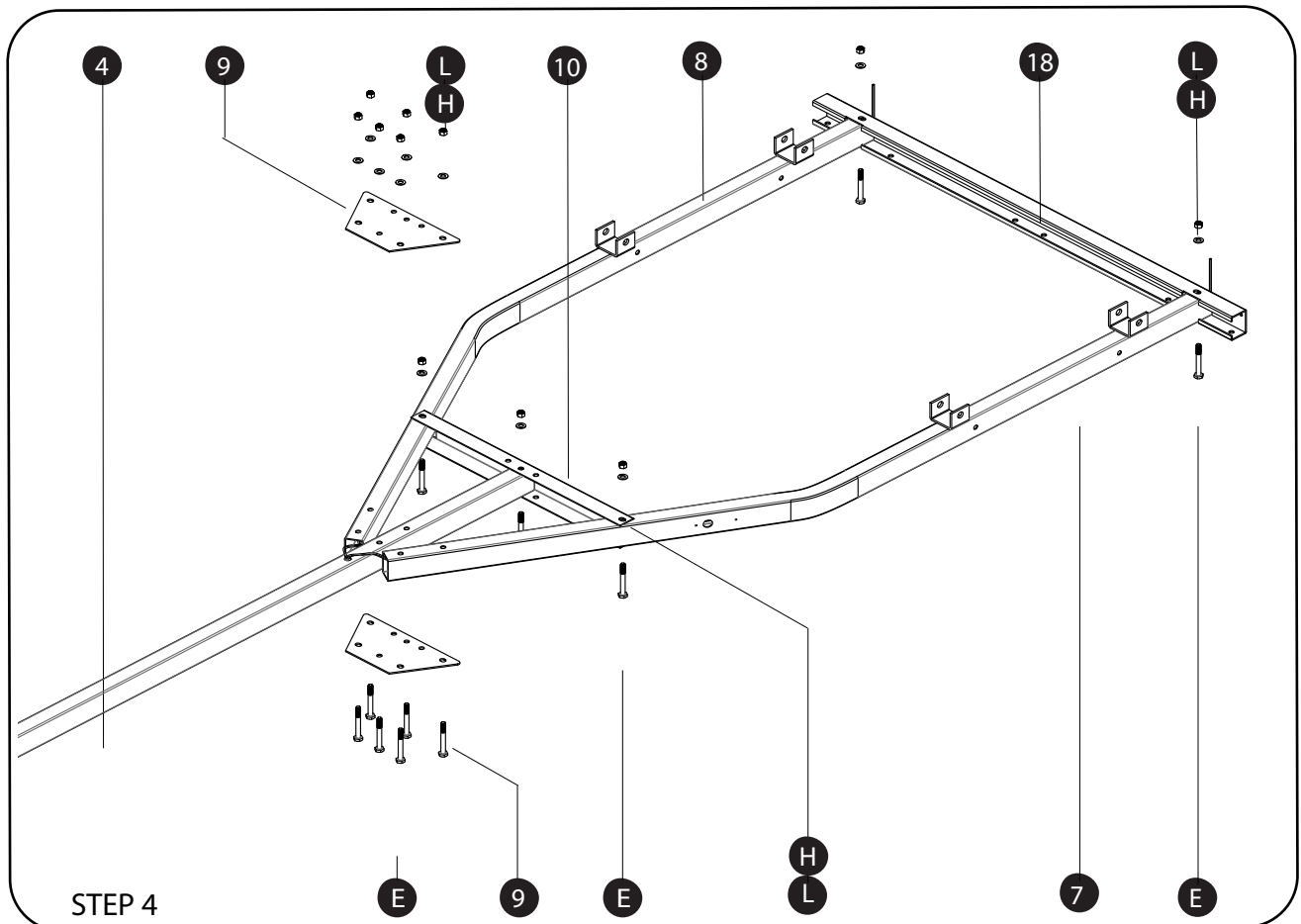

STEP 4: Lift frame parts off floor and set on temporary blocking. Assemble frame using Bolt M10x85mm (E), Flat Washer M10 (H), and Nut M10 (L) - quantity 11. Do not fully tighten bolts until all the frame parts (4,7,8,10, & 18) are attached. Leave Bolts (E) finger tight initially then fully tighten after frame parts are attached and frame is squared. Be careful not to damage wires inside the frame parts.

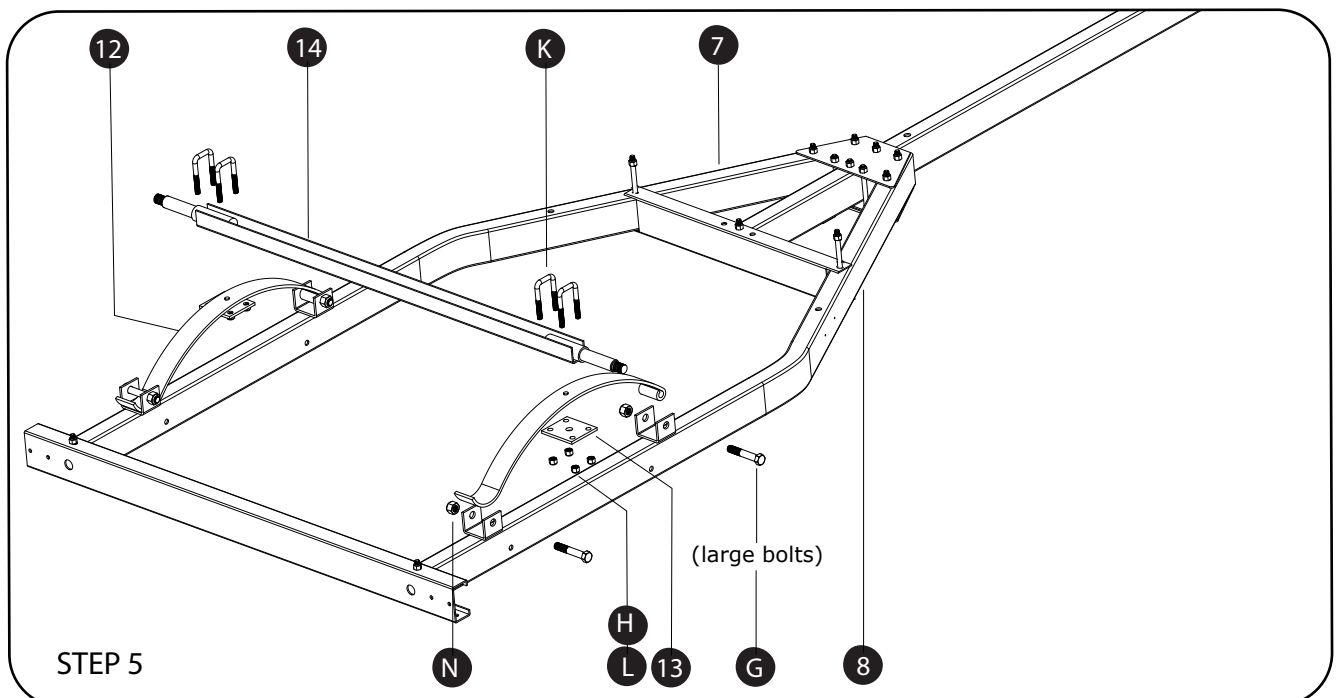

ASSEMBLY STEPS

STEP 5: Insert Spring (12) into U-brackets of Right Side Rail (7) with the eye of the spring forward as shown. Secure with two Bolts M14 (G) and Nuts M14 (N). Assemble Spring (12) into Left Side Rail (8) in the same manner.

Place Axle (14) on top of Springs (12) so the heads of bolts on springs engage into the locating holes in the Axle (14). Place Spring Plate (13) under Spring (12) and pass two U-Bolts M10 x 75mm (K) through Axle and Spring Plate. Secure together using Flat Washer M10 (H) and Nuts M10 (L). Be sure that the center hole of Spring Plate is fit over the small locating bolt in the Spring. Assemble both sides in the same manner. Fully tighten all Nuts.

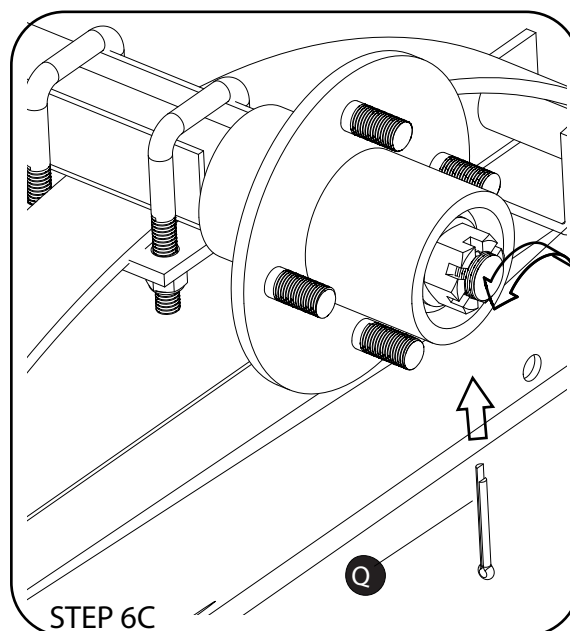
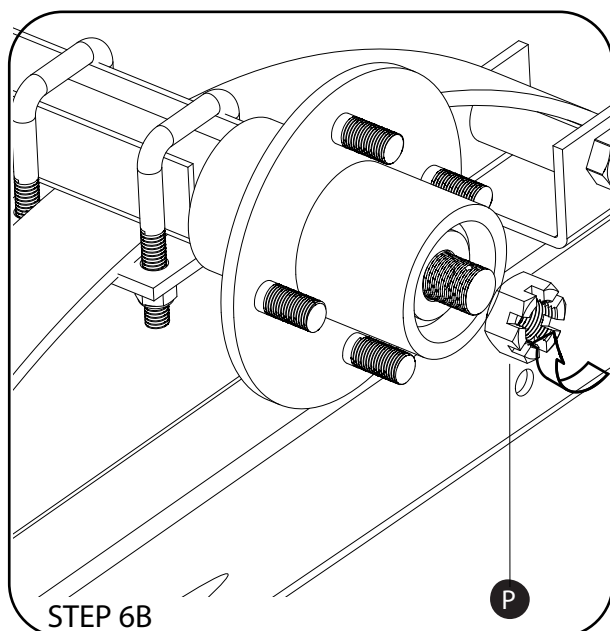
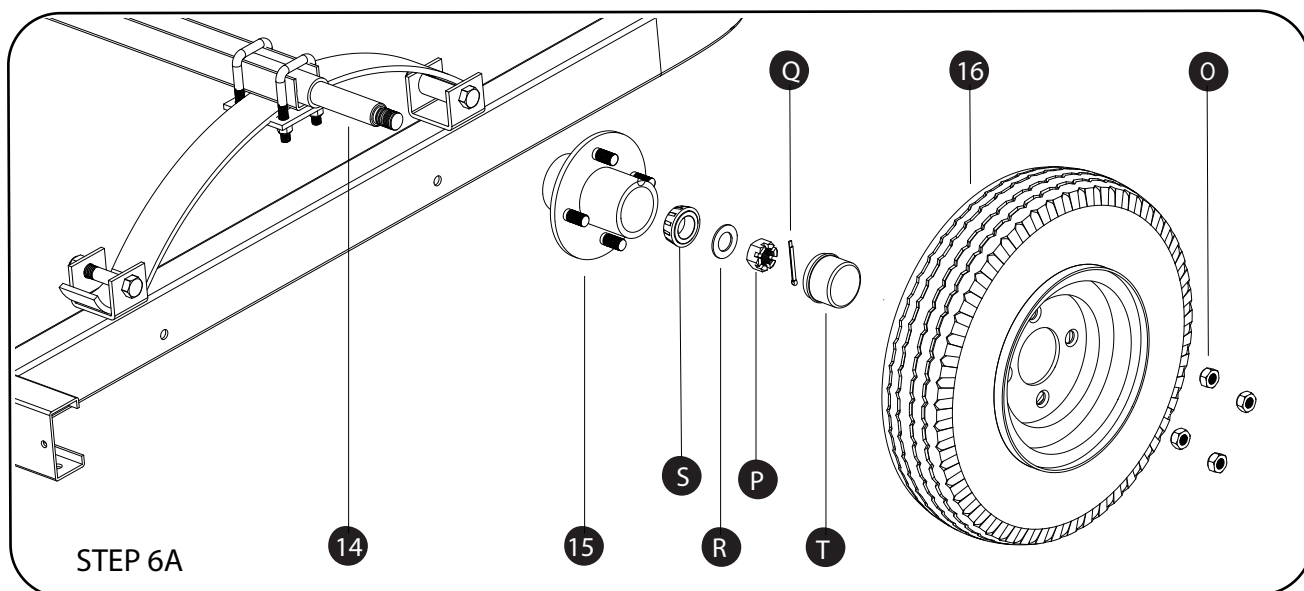

ASSEMBLY STEPS

STEP 6A: Remove Dust Cap (T) from Hub Assembly (15). Strike Dust Cap (T) radially with a rubber or plastic mallet until cap starts to walk out. Insert and twist a wide flat screw driver to push Dust Cap out of Hub.

Clean Axle (14) bearing surfaces and apply extra grease on step surface where the inner seal rides. Carefully slide Hub Assembly (15) onto Axle spindle. Then assemble outer Bearing (S) and Flat Washer 3/4" (R) as shown. Repeat assembly on the other side.

STEP 6B: Tighten Castle Nut (p) snugly against Flat Washer (R) using a wrench.

STEP 6C: Back off Castle Nut until Cotter Pin (Q) can be inserted through slot in the Castle Nut (P) and the hole in the Axle spindle. Insert Cotter Pin fully and bend over end of axle. Assembled Hub should rotate freely, but there should be no axial play between Hub Assembly (15) and Axle (14). Repeat assembly on the other side.

Fill Dust Cap (T) ¼ full of grease and carefully tap it into Hub Assembly (15) using a plastic or rubber mallet. Add grease to Hub Assembly using a grease gun. Normaly, 15-20 pumps is sufficient. Repeat assembly on the other side.

Slide Tire/Rim Assembly (16) onto Hub Assembly (15) with air valve facing outboard. Assemble Lug Nuts (O) with chamfered edge inward toward Rim and tighten to 80-90 ft*lbs. Repeat assembly on the other side. Retorque Lug Nuts after first 50 miles of use.

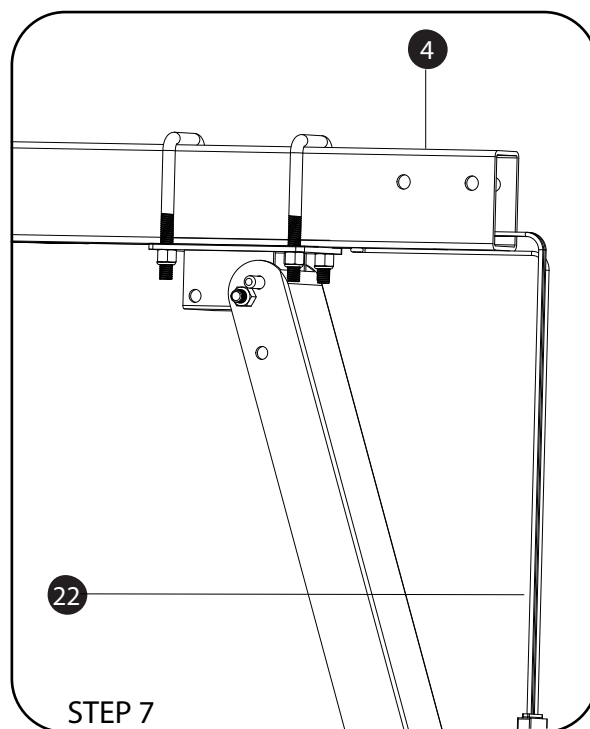
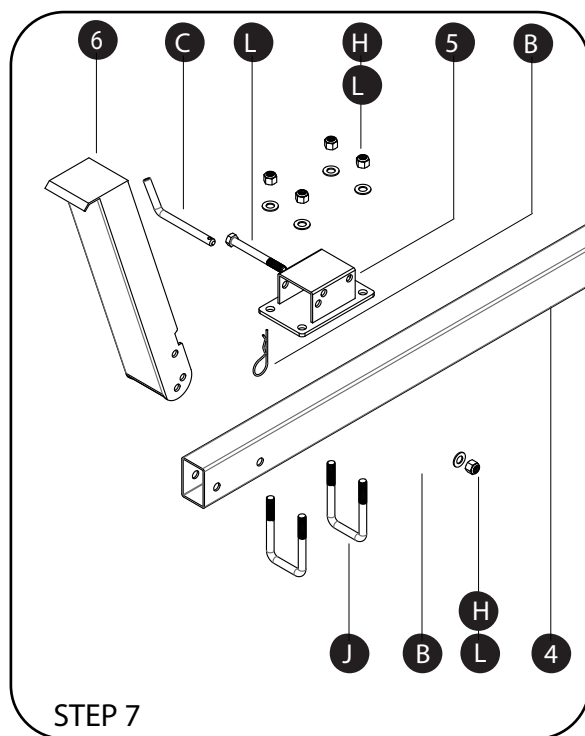

ASSEMBLY STEPS

STEP 7: Place the front edge of Stand Base (5) 8" (205mm) from front edge of Towbar (4) and fasten together with U-Bolts M10 x 85mm (J), Flat Washer M10 (H) and Nut M10 (L) as shown. Place Stand Leg (6) over Stand Base (5) and fasten together with Bolt M10 x 85mm (E), Flat Washer M10 (H), and Nut M10 (L) as shown. Note: pivot bolt is inserted in the center hole of the 3 holes. Insert Pin (C) in top hole when Stand Leg is extended and add Hairpin Cotter (B).

Together with a helper, flip the trailer right side up onto its wheels.

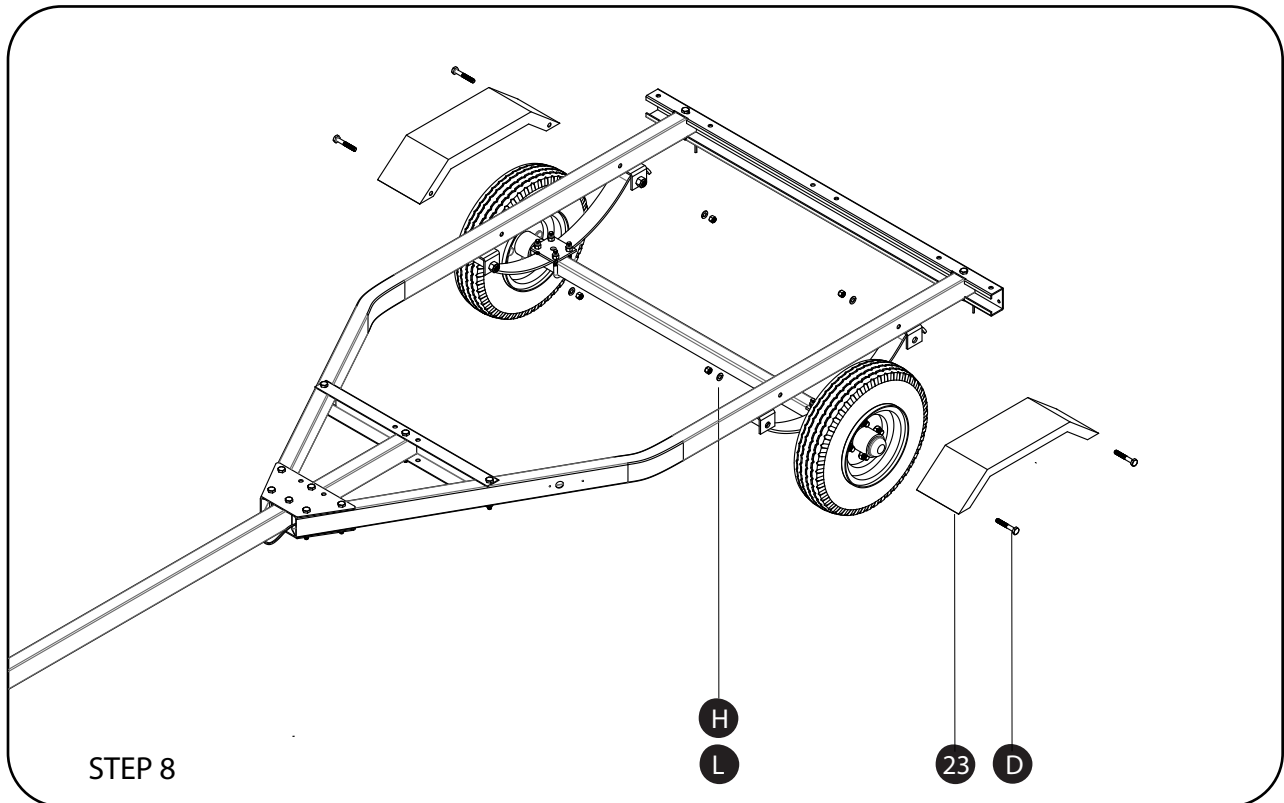

STEP 8: Fasten Fenders (23) to Side Rails using Bolts M10 x 60mm (D), Flat Washer M10 (H), and Nut M10 (L) as shown.



STEP 9A

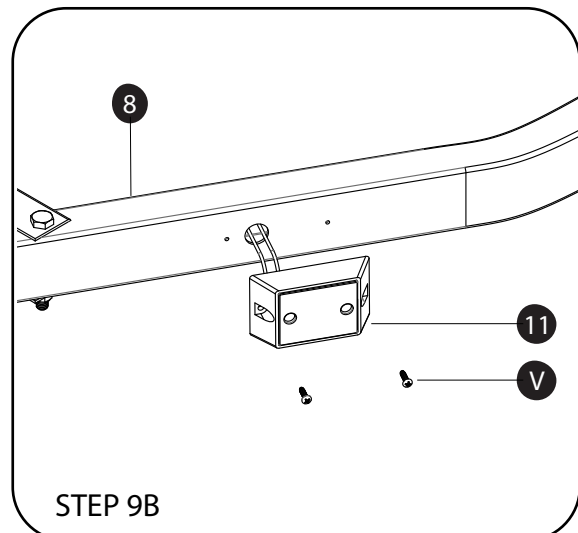

ASSEMBLY STEPS

STEP 9A: Route brown (+) and white (-) wire out of the 20mm access hole in Side Rail and connect to Side Running Light (11) wires. Fasten wire connectors brown to brown and white to white. Wrap connections in electrical tape. Repeat procedure on the right side.

STEP 9B: Push wire into Side Rail and fasten Side Running Light (11) to Side Rail using Screws (V). Repeat procedure on the right side.

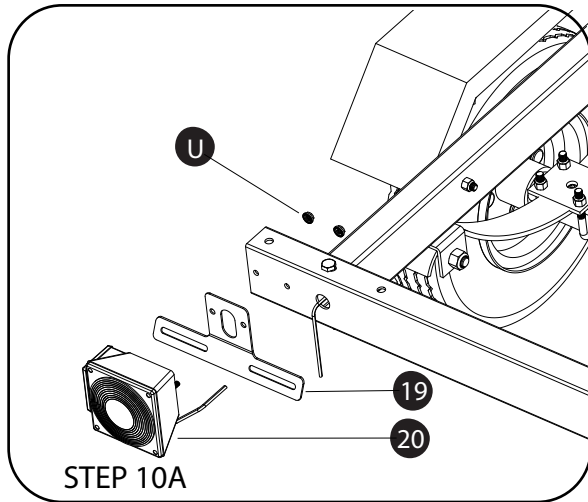

STEP 10A: Assemble Left Tail Light (20) and License Plate Bracket (19) with Nuts $\frac{1}{4}$ -20unc (U) as shown. Assemble Right Tail Light (21) with Nuts $\frac{1}{4}$ -20unc (U).

STEP 10B: Connect tail light wires to Wiring/Plug Assembly (22). Match wire colors. Wrap connections in electrical tape. Extra wire can be stuffed back into frame.

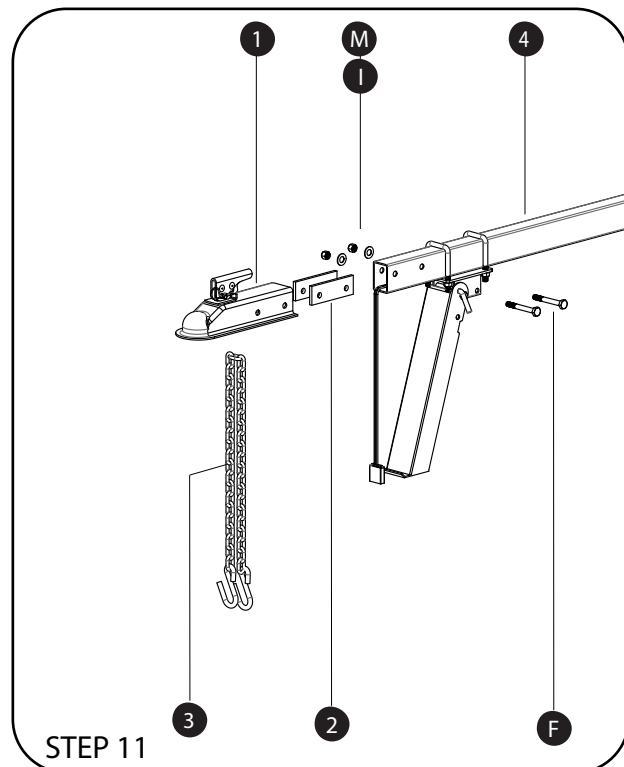

ASSEMBLY STEPS

STEP 11: Assemble Coupler Base (2) on each side of Towbar (4) as shown. Place Coupler (1) over the two Coupler Base spacers and insert two Bolts M12 x 80 (F). Find the center link of Chain (3) so that Chain is the same length on each side. Capture center link of Chain with the forward Bolt M12 x 80 (F) inside the Towbar (4). Assemble Flat Washer M12 (I) and Nut M12 (M) onto the bolts and fully tighten.

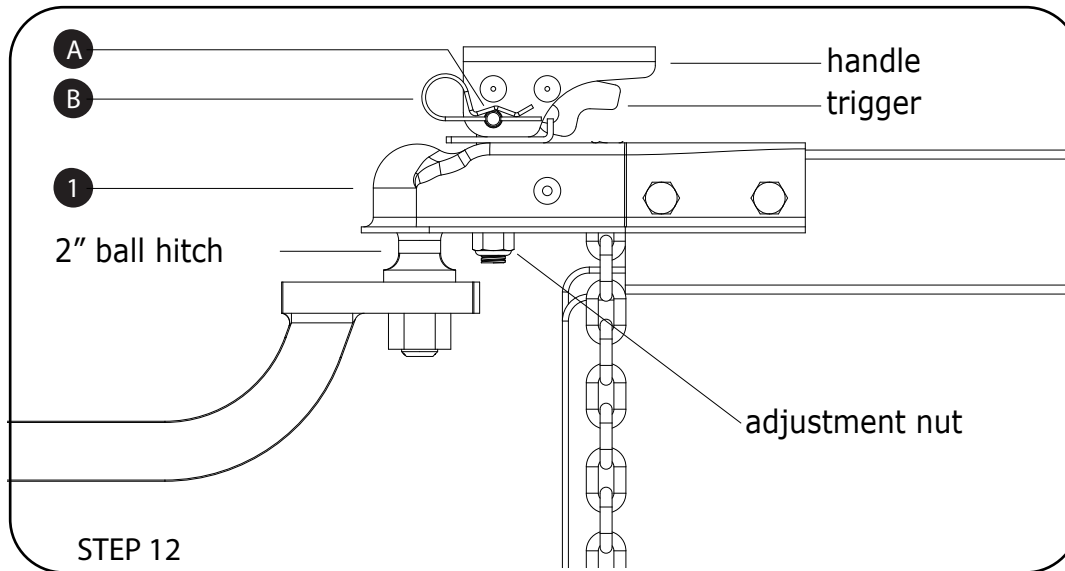

STEP 12: Coupler (1) can only be used with a 2" ball hitch and must be adjusted before first use. Remove Hairpin Cotter (B), Safety Pin (A), release coupler handle, and hitch to vehicle. Latch handle down until trigger lock engages. Pull up and down on Coupler to see if the ball is captured snugly in Coupler. There should be no/little play between the ball and Coupler. If there is play, tighten the adjustment nut until no play is present. If the nut is too tight, the handle will not lock.

Note: Grease can be used to reduce friction between the ball and hitch.

SAFE USE AND OPERATION OF THE LCI-8791P RIGHT-ON ROAD TRAILER

1. Double Check Assembly Steps:
 - Recheck that the instructions were followed and all fasteners are tightened.
 - Confirm all lights are working.
 - Confirm Coupler is adjusted properly and fits snugly to 2" ball hitch.
 - Confirm tire pressure of 30-60 PSI
2. Trailer Licensing:
 - Consult your State Department of Motor Vehicles for information on proper licensing.
 - Prior to assembling your trailer take out "CERTIFICATE OF ORIGIN" from carton #2. This document is shipped with the Towbar (4).
3. Towing Vehicle:
 - Make sure vehicle is capable of towing the load.
 - Excessive speed increases chances of a car-trailer accident.
 - Know how to properly control your towing vehicle-trailer combination under all conditions. Remember the loaded weight of the trailer will increase braking and stopping distances.
4. Safety Chains:
 - Be sure to use Safety Chains. Do not allow chains to drag on ground.
 - Check both Safety Chains are the same length and are not damaged.
5. Loading:
 - Never overload the trailer. The maximum load for the trailer is 300lbs.
 - Never carry a passenger on the trailer.
 - Check load is properly strapped-down to the trailer.
6. Lights:
 - Check lights are working before every use and periodically during trips.
 - Replace and broken lenses, reflectors, or bulbs.
 - Bulbs used in Tail Lights are No. 1157 - Stop and Tail.
 - Bulbs used in Running Lights are No. 1895
7. Tires:
 - Check tires for wear and proper inflation before every use and periodically during trips.
 - Tire pressure should be kept at 30-60PSI
 - Check and tighten Lug Nuts. Torque 80-90 ft*lbs. (Retorque after first 50 miles)
8. Maintenance:
 - Inspect hitch and ball for damage before every use.
 - Disassemble, inspect, and repack wheel bearings with automotive grease yearly or every 4000 miles.
 - If you are unable to repack wheel bearings, take the trailer to a service garage for advice and service.

Reporting safety defects

If you believe that your vehicle has a defect which could cause a crash or could cause injury or death, you should immediately inform the National Highway Traffic Safety Administration (NHTSA) in addition to notifying Long Chih Industrial Company Limited.

If NHTSA receives similar complaints, it may open an investigation, and if it finds that a safety defect exists in a group of vehicles, it may order a recall and remedy campaign. However, NHTSA cannot become involved in individual problems between you, your dealer, or Long Chih Industrial Company Limited.

To contact NHTSA, you may call the Vehicle Safety Hotline toll-free at 1-888-327-4236 (TTY: 1-800-424-9153); go to <http://www.safercar.gov> ; or write to: Administrator, NHTSA, 1200 New Jersey Avenue SE., Washington, DC 20590. You can also obtain other information about motor vehicle safety from <http://www.safercar.gov>.

Long Chih USA Customer Service Center: Toll Free: 800-576-7888 for advice and service.

LCI-8791P Right-On Road Trailer

Right-On Trailer Co. LLC
3025 McCully Drive NE
Atlanta, GA 30345
rightontrailer@comcast.net
www.rightontrailer.com

Manufactured for Right-On Trailer Co. by
Changzhou Zhongmao Machinery Co.,Ltd
#16 Shengda Road
Luoxi Town, Xinbei District
Changzhou, Jiangsu, CHINA,
Zip code: 213136

SAFE USE

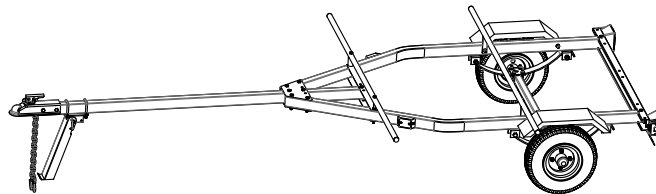

Bolt on accessory TS-792R Multi-Sport Crossbars (65" wide)

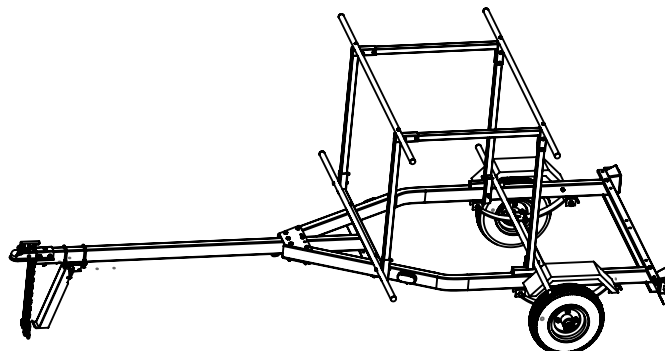

Bolt on accessory TS-793R Multi-Sport Rack (65" wide)

ACCESSORY APPLICATIONS