

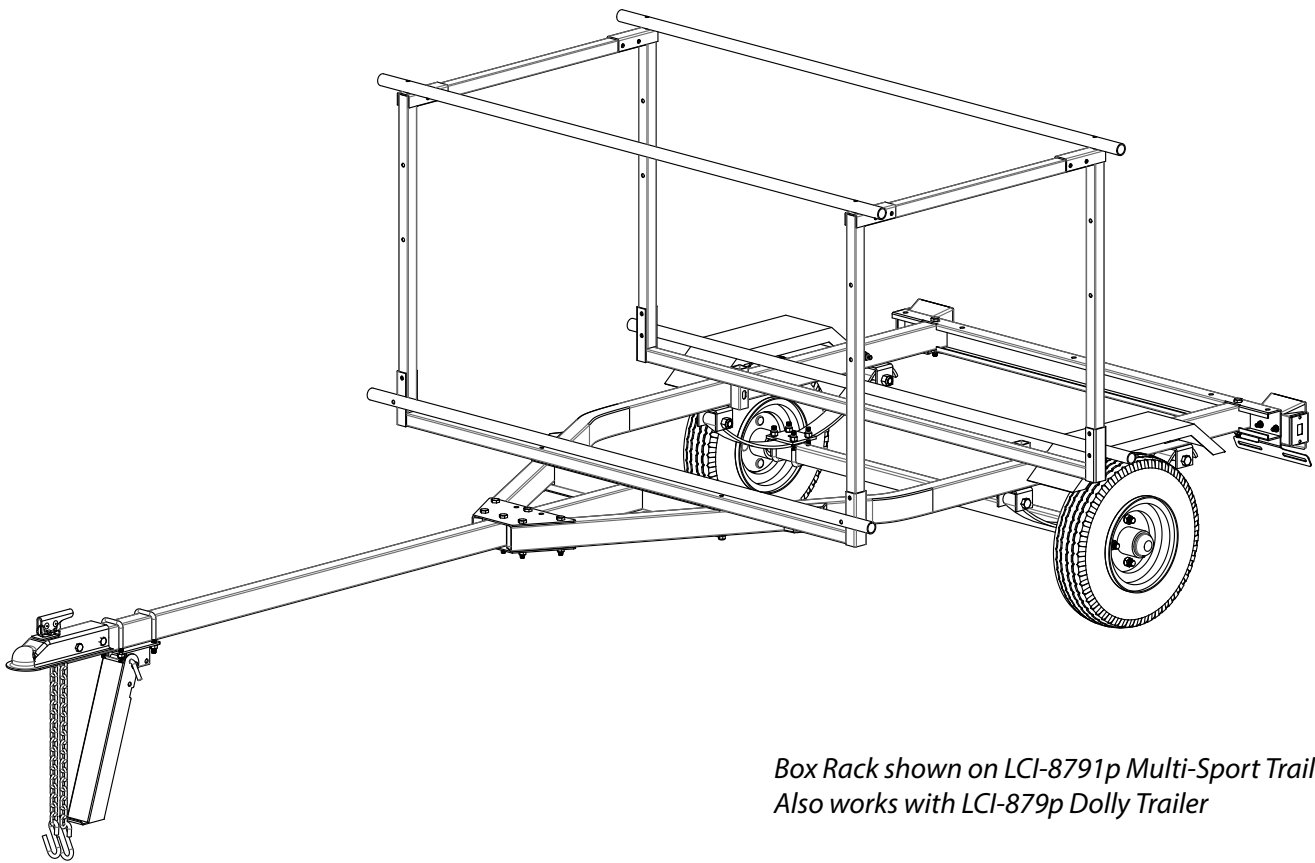

Revision: C1



*Box Rack shown on LCI-8791p Multi-Sport Trailer
Also works with LCI-879p Dolly Trailer*

TS-794R Box-Sport Rack
Shipping Weight: 38 lbs
Max Load Capacity: 300 lbs



Approximate Assembly Time
1/2 hour

Parts List & Assembly Instructions

The tools and supplies you will need:

- Box wrenches (13mm & 17mm)
- Sockets (13mm & 17mm)
- Clear or Black Silicone Caulk (not included)

Identify and layout all bolts and fasteners before starting assembly

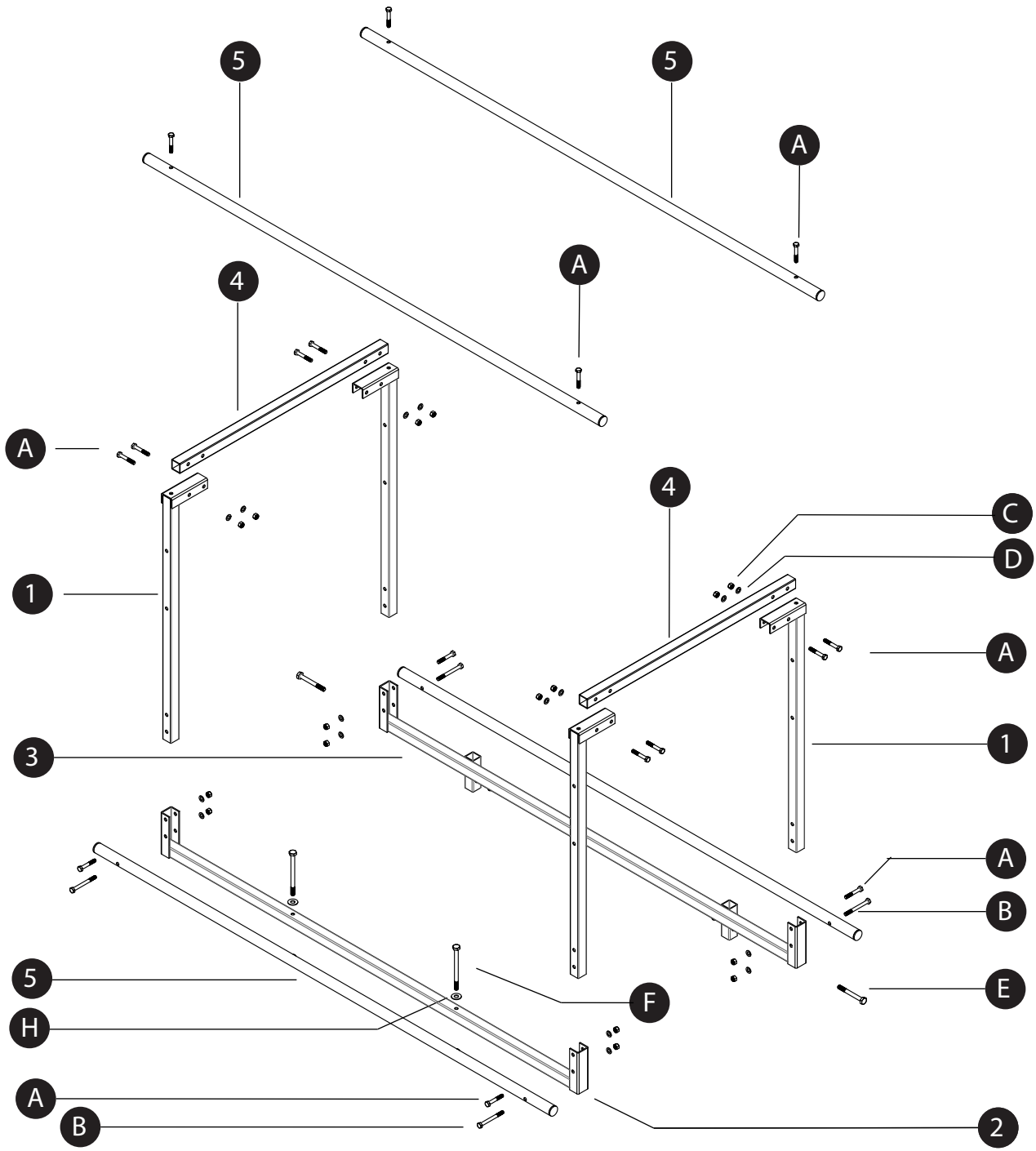

EXPLODED PARTS VIEW

Rack Parts		
No.	Item	Qty
1	Vertical Bracket	4
2	Front Foot Bracket	1
3	Rear Foot Bracket	1
4	Fore-Aft Bracket	2
5	Crossbar	4

Hardware		
No.	Item	Qty
A	M8 x 50mm Bolt	16
B	M8 x 80mm Bolt	4
C	M8 Lock Nut	16
D	M8 Flat Washer	16
E	M10 x 85mm Bolt	2
F	M10 x 110mm Bolt	2
G	M10 Lock Nut	4
H	M10 Flat Washer	4

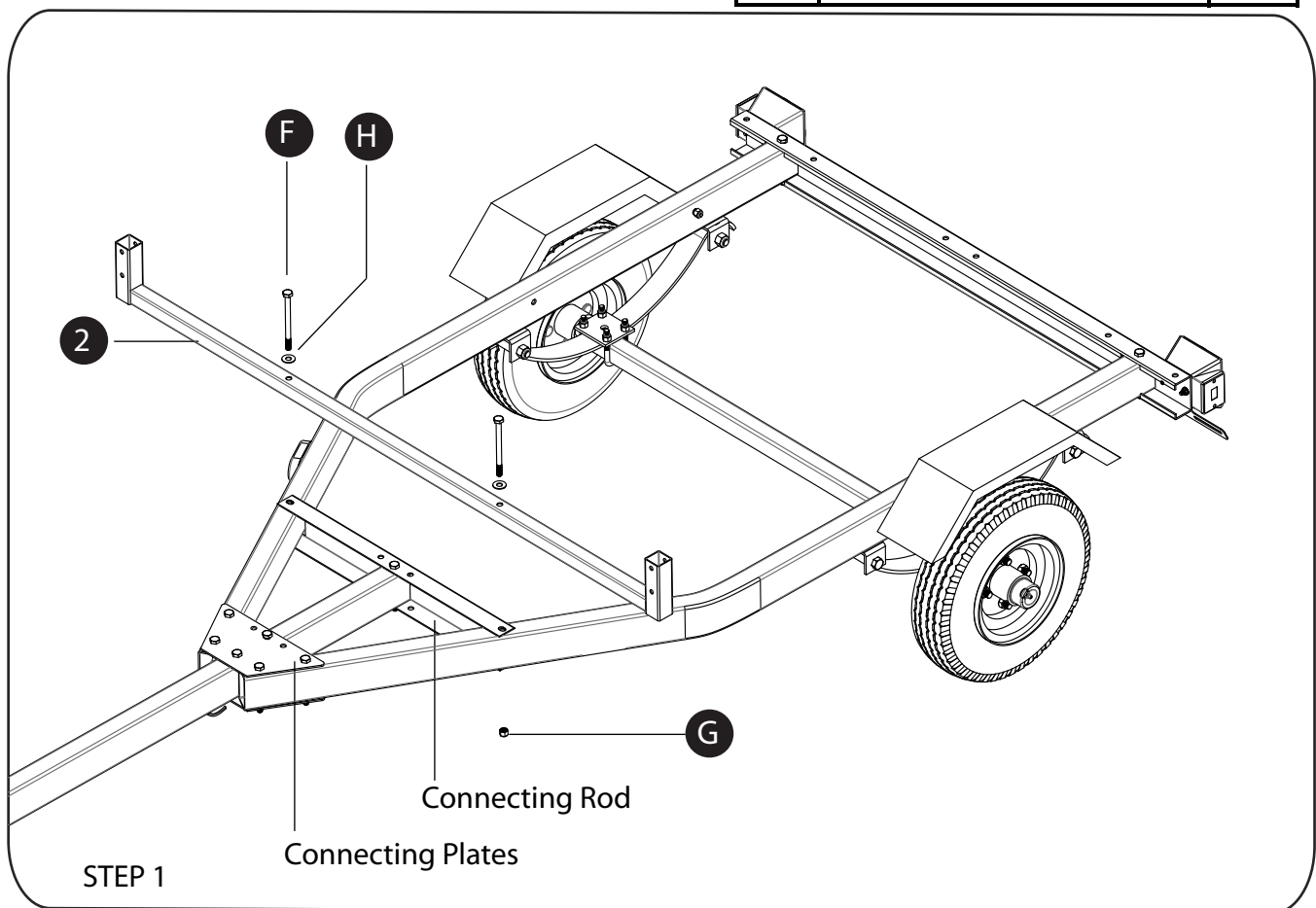

STEP 1: Disassemble M10 x 85mm Bolts (qty 2) that pass through the Connecting Rod part of the trailer - these will be replaced by longer bolts. Place the Front Foot Bracket (2) on the Connecting Rod so the center bolt head sits in the clearance hole of the Foot Bracket. Assemble the M10 x 110mm Bolts (F) through the M10 Flat Washers (H), Front Foot Bracket (2), and through the Connecting Rod of the trailer. Finger tighten bolts and nuts at this time.

Note: It is possible that the M10 x 110mm Bolts (F) will not align through the Foot Bracket (2) and Connecting Rod. If this happens, loosen the M10 x 85mm Bolts (qty 6) that pass through the Connecting Plates and tap the M10 x 110mm Bolts (F) through. Retighten the M10 x 85mm Bolts (qty 6).

PARTS LIST

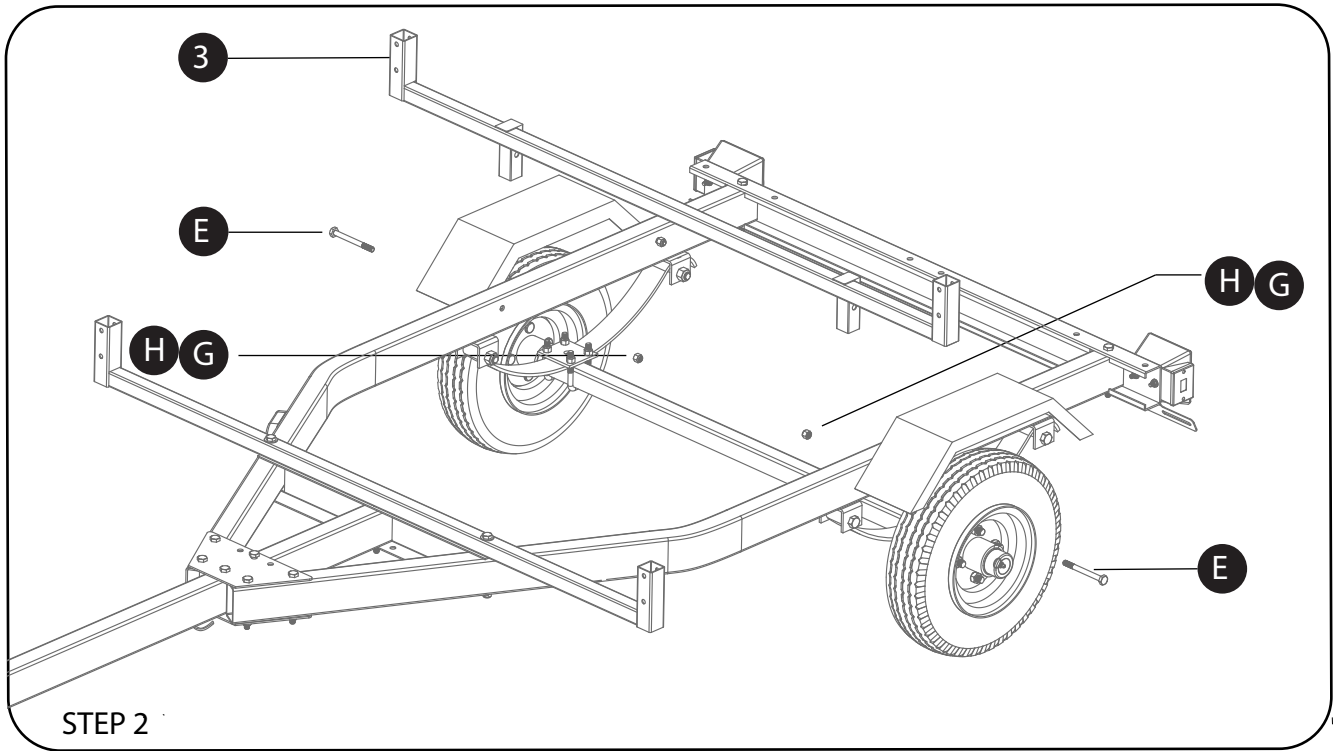

STEP 2

STEP 2: Disassemble M10 x 60mm Bolts (qty 2) that pass through the front Fender hole and Side Rails of the trailer - these will not be reassembled. Place the Rear Foot Bracket (3) in position shown. Assemble the M10 x 85mm Bolts (E) through the Fender and Rear Foot Bracket. Finger tighten bolts and nuts at this time.

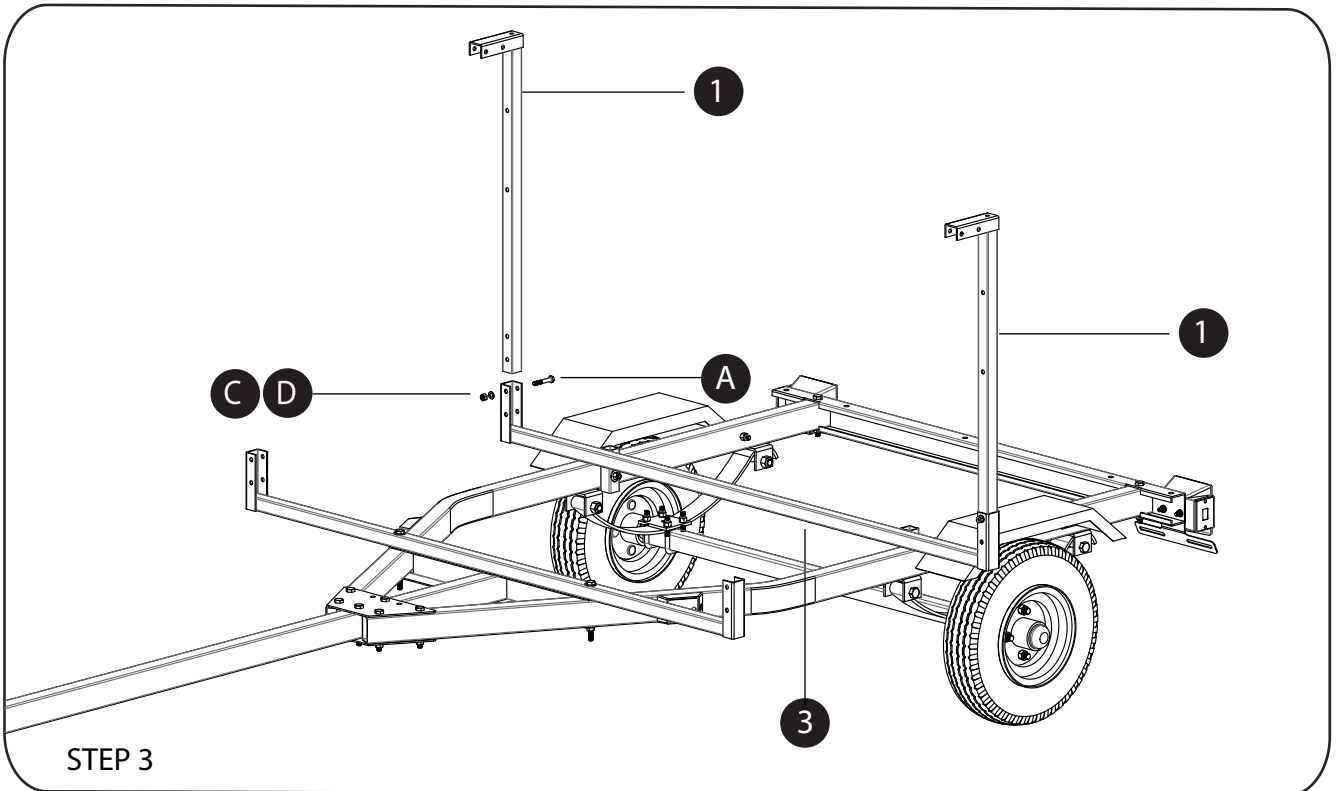

STEP 3

STEP 3: Assemble the Vertical Bracket (1) into the Rear Foot Bracket (3). Use M8 x 50mm Bolt, M8 Flat Washer (D) and M8 Lock Nut (C) to fasten together finger tight. Note the M8 x 50mm Bolt that fastens the Vertical Bracket (1) to the Rear Foot Bracket (3) goes in the top hole. Repeat this procedure for the opposite side. Finger tighten bolts and nuts at this time.

ASSEMBLY STEPS

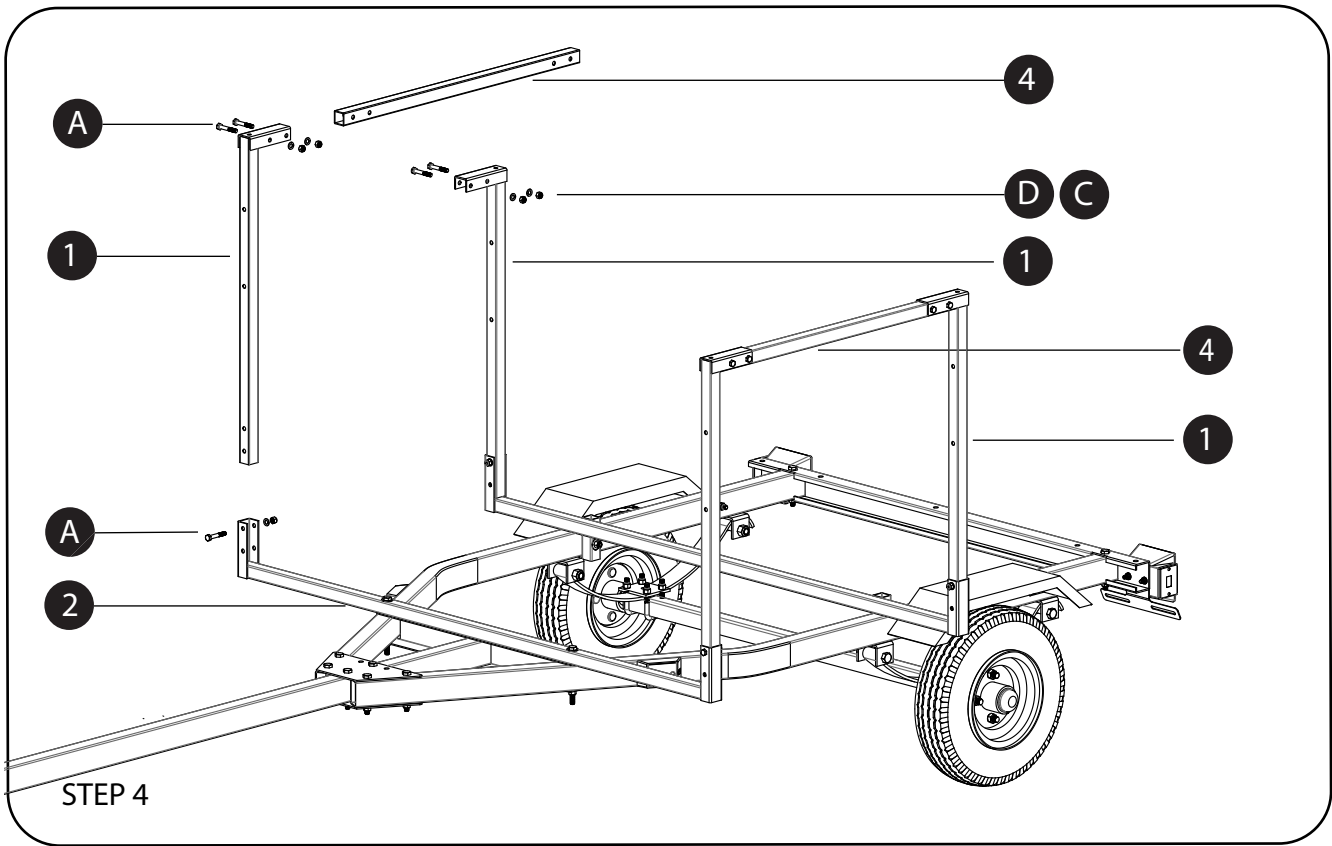

STEP 4: Assemble the Vertical Bracket (1) into the Front Foot Bracket (2). Use M8 x 50mm Bolt, M8 Flat Washer, and M8 Locking Nuts to fasten together through top hole. Assemble the Fore-Aft Bracket (3) into the two Vertical Brackets (1) with qty 4 M8 x 50mm bolts. Tighten locking M8 Nuts finger tight. Repeat this procedure for the opposite side.

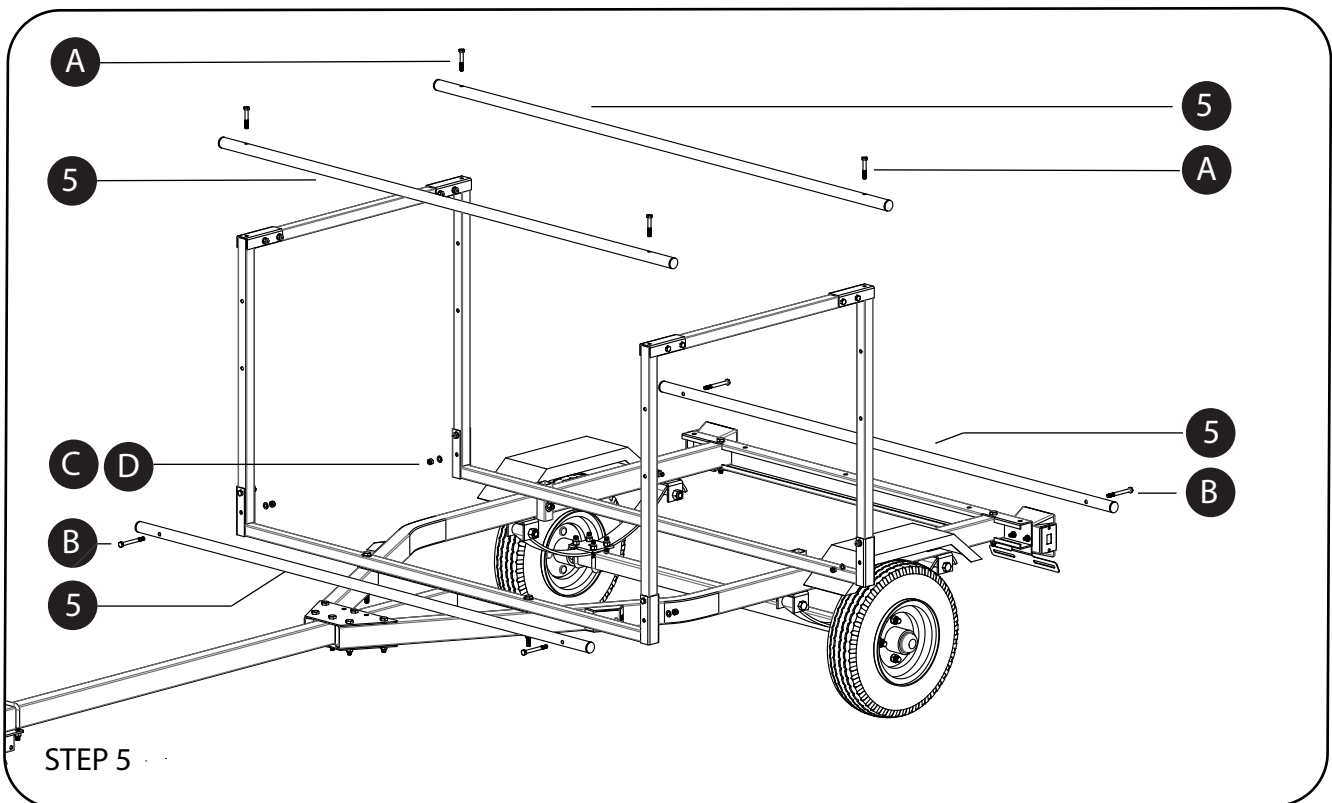

ASSEMBLY STEPS

STEP 5: Assemble the top 2 Crossbars (5) using (qty 4) M8 x 50mm Bolts (A). The bolts will screw into weld nuts that have been installed in the Vertical Brackets (1). Assemble the bottom 2 Crossbars (5) using (qty 4) m8 x 80mm Bolt (B), M8 Flat Washer (H), and M8 Lock Nut (G) as shown. Finger tighten bolts and nuts at this time.

STEP 6: Check for squareness of the Box Rack and tighten all nuts and bolts. Go through twice and check that all the bolts are fully tightened. Do not forget the M10 bolts in Steps 1 and 2.

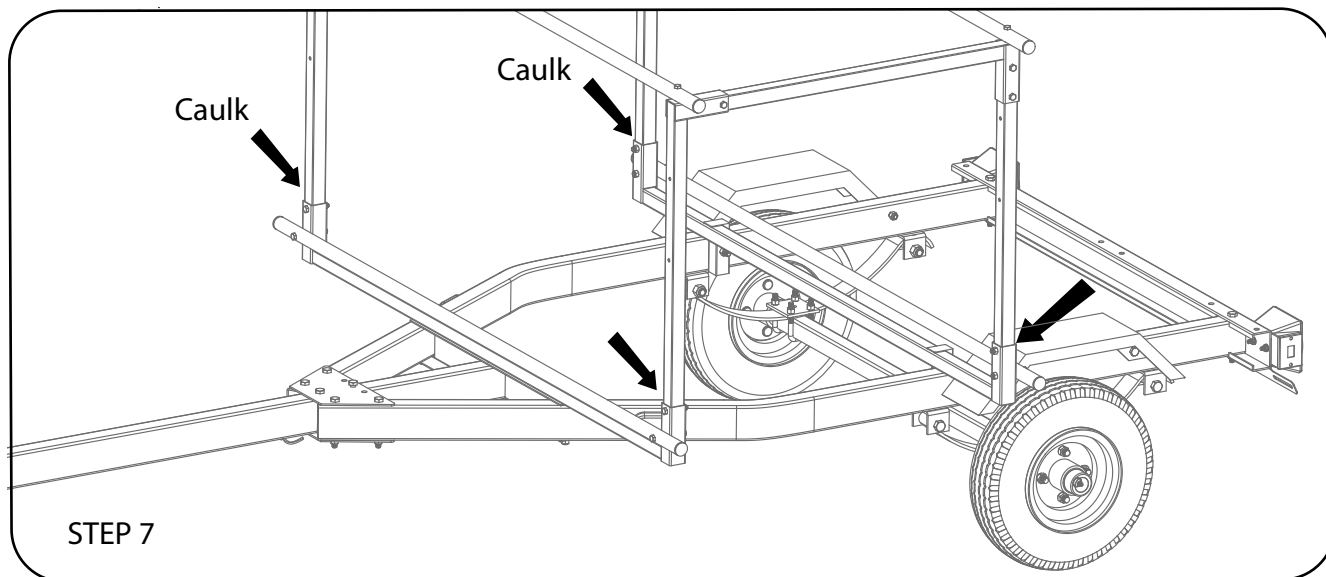

STEP 7: Apply black or clear silicone caulk all around the 2 joints where the Foot Brackets (3&4) meets the Front Vertical Brackets (1). This step will prevent premature rusting of the Foot Brackets.



Shown with qty2 accessory bike racks and qty 2 sets of 30" Pads

The Crossbars are designed to work with all roof rack accessories from companies like Yakima®, and Thule® (all sold separately).

Right-On Trailer Co. LLC
Atlanta, GA USA
info@rightontrailer.com
www.rightontrailer.com

ASSEMBLY STEPS